

Hay Bale Seat

Plan

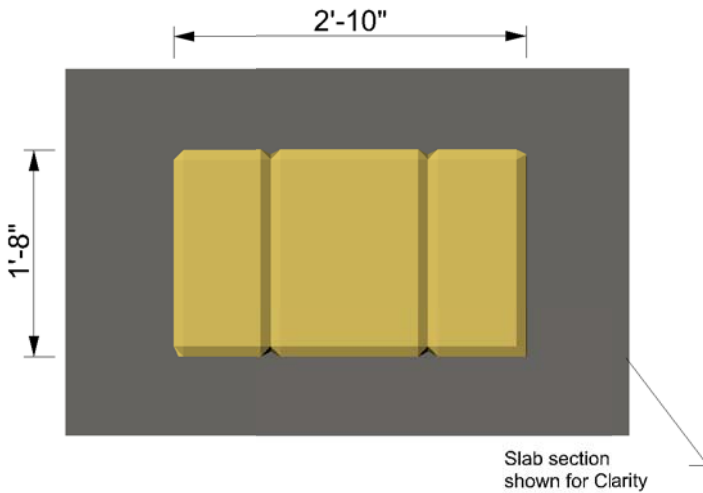

Iso

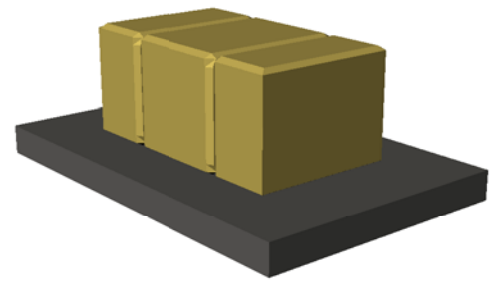

Elevation

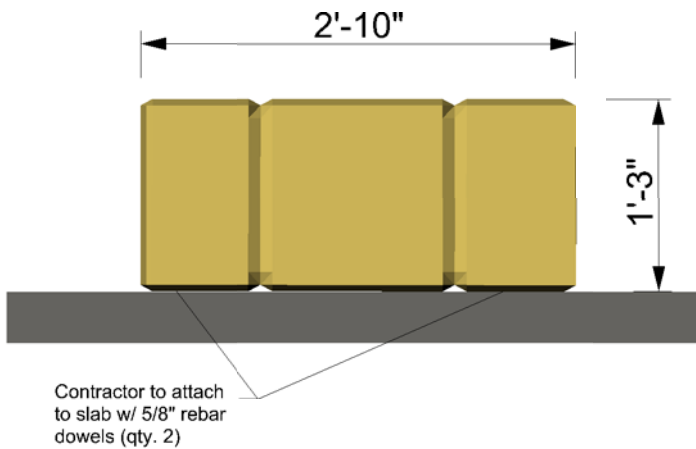

Iso

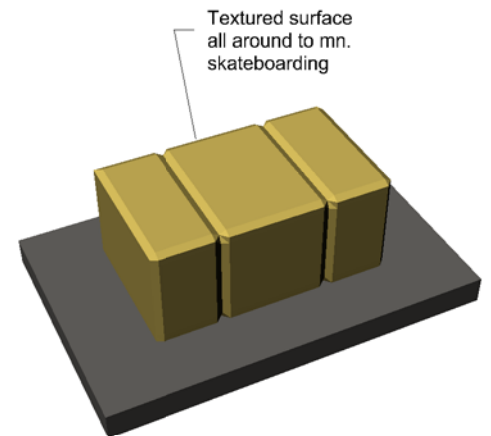

General Notes:

Quantity = 1
 Material = Polyfibercrete
 Finish/Texture = light sandblast
 Concrete Color = grain
 Stain = natural hay color
 Sealer = standard

Height of Built-in Footing: _____
 Scale: nts
 Weight each: 900 lbs.
 Total Weight: tbd

Approved By:

 Name Date



UNIVERSAL
 precast concrete

Contractor: tbd	Project: tbd	Desc.: Hay Bale Seat	Model #: SHB-34
Contact: Gary	Phone: 530-242-6116	Fax: 408-799-8888	Email: Gary@nsp3.com
Drawing: Dan	Plant: 530-243-6477	Date: 15 Dec, 2009	Weight: 2400 lbs. each Rev: na Page: 1/1